

Email Setup - Android

Please Note

The following steps were created using a device with Android 9. The designations of the individual menu items may vary slightly for devices from other manufacturers.

Step 1

Tap the **Settings** icon (typically displayed as a gear).

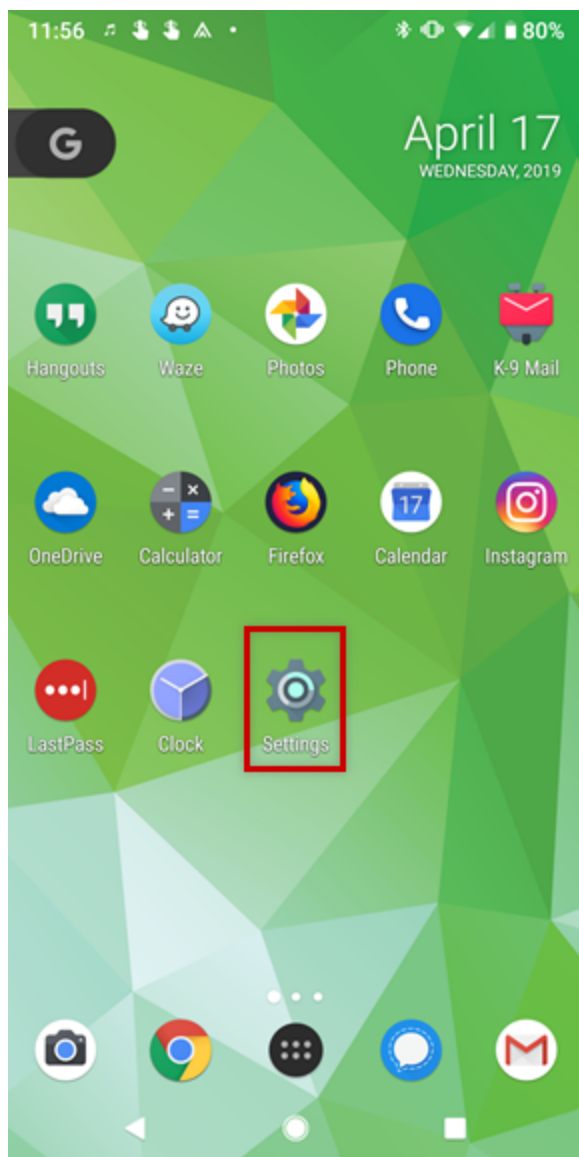

Step 2

Go to Accounts.

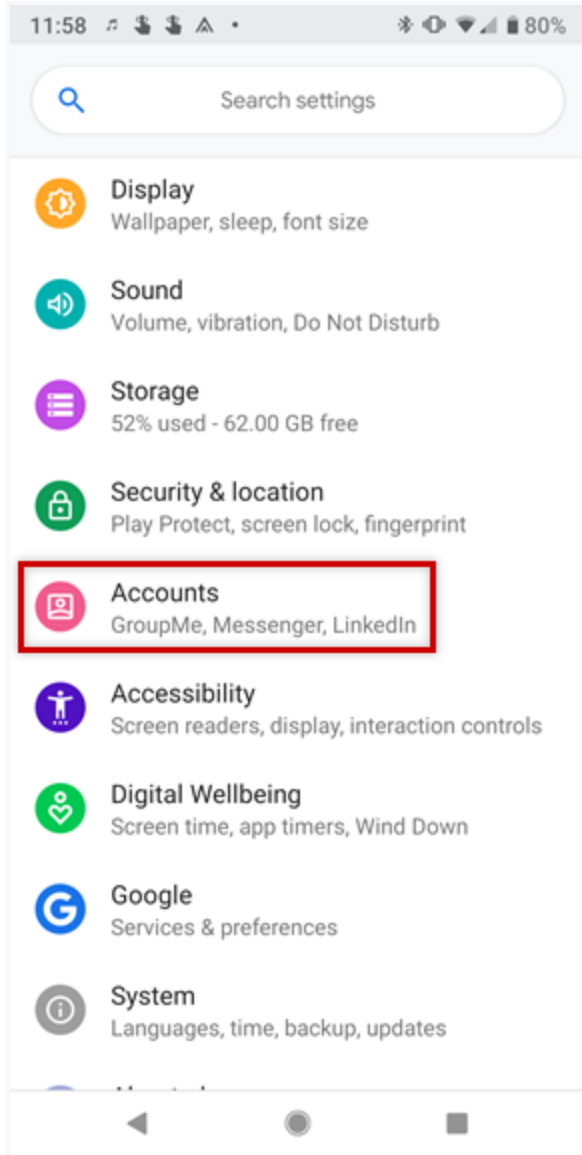

Step 3

Tap **Add Account**.

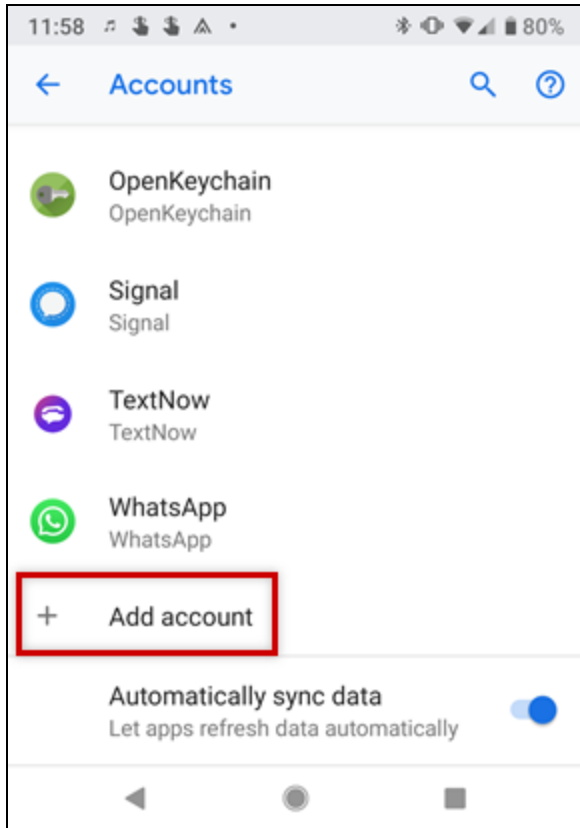

Step 4

Select **Personal (IMAP)**.

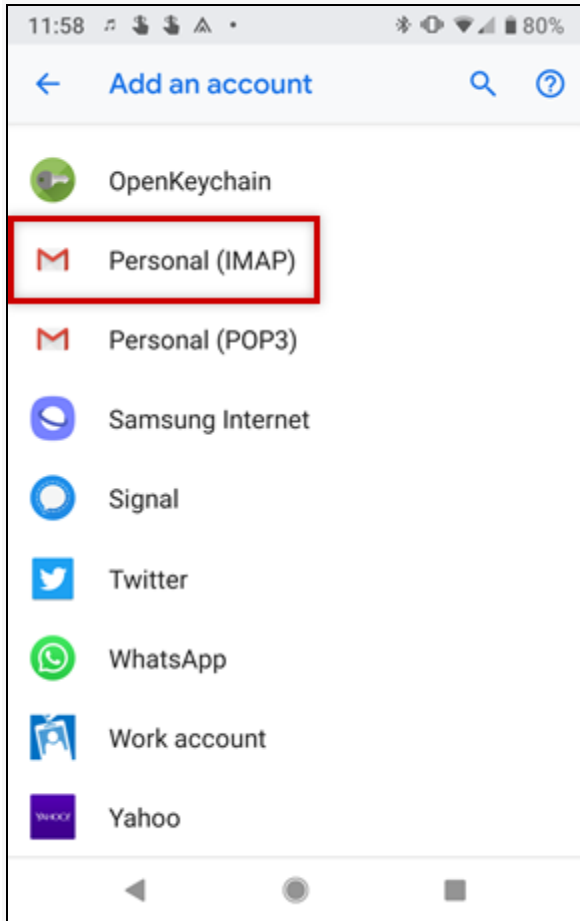

Step 5

Enter your email address and tap **Next**.

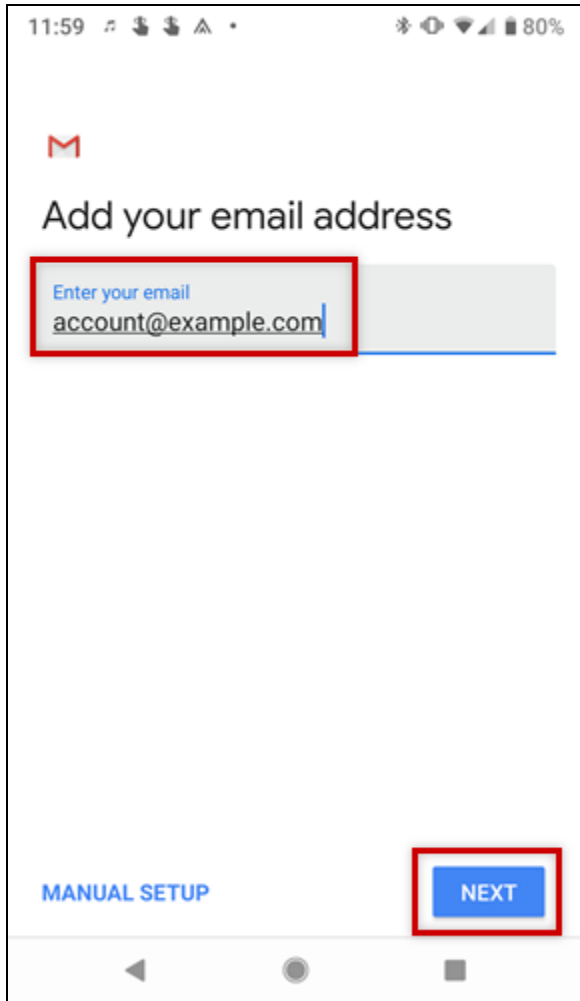

Step 6

Enter the password to your email address and tap **Next**.

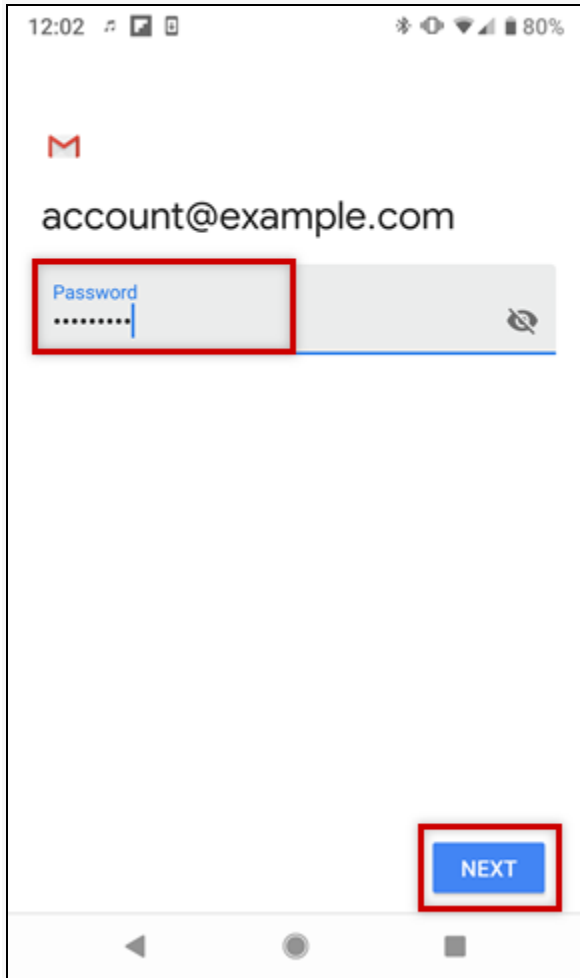

Step 7

In the Server field, enter `imap.ionos.com` and tap **Next**.

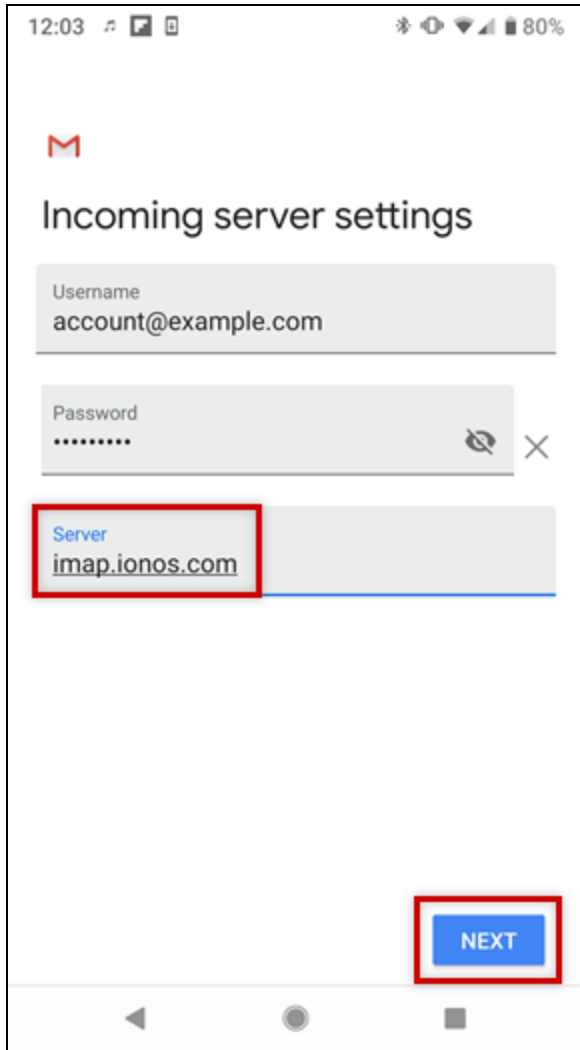

Step 8

In the SMTP Server field, enter smtp.ionos.com and tap **Next**.

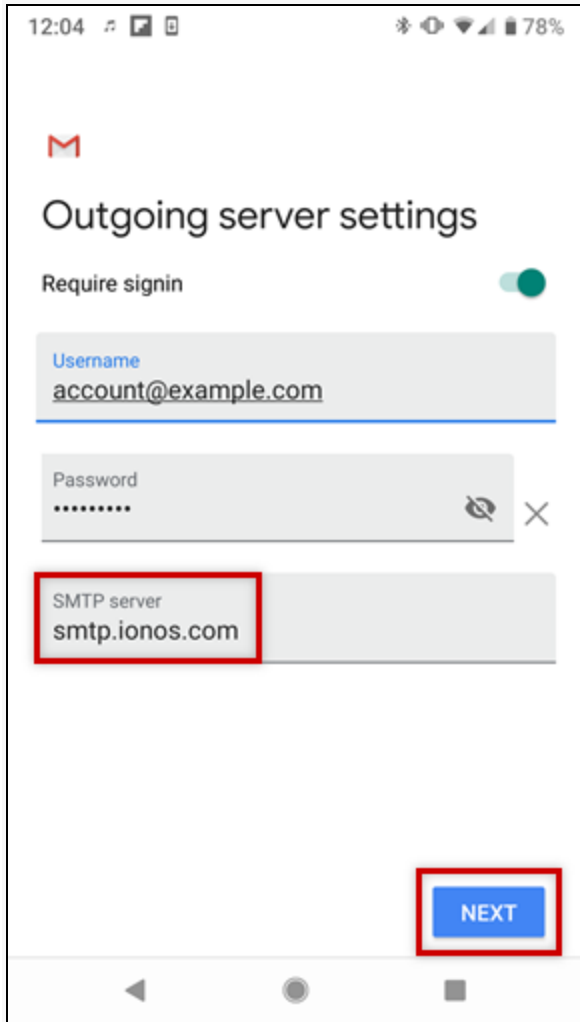

Step 9

Choose your desired Account Options and tap **Next**.

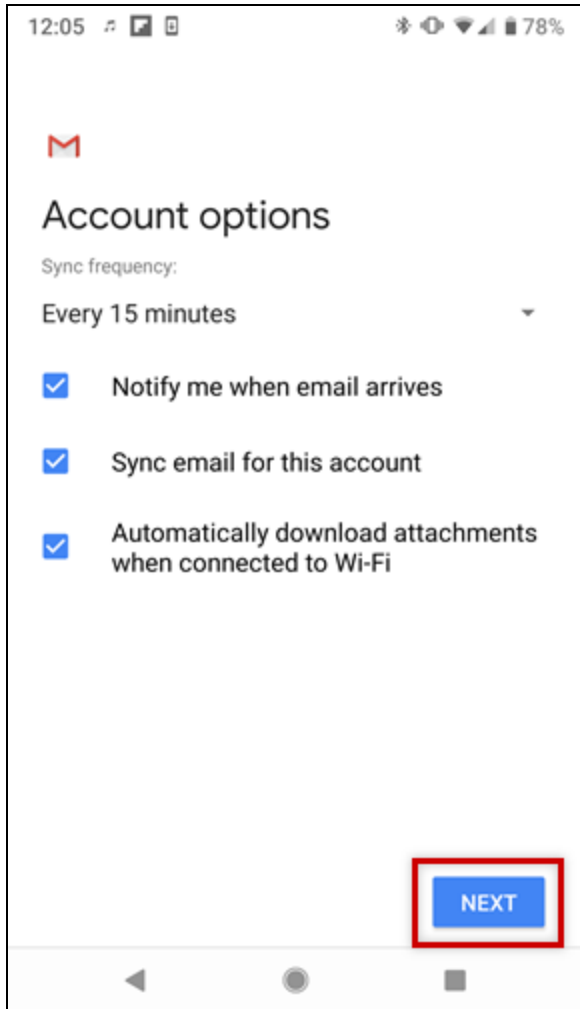

Step 10

If you would like, you can change the default Account Name, which helps you differentiate this account from other email accounts on your device, or Your Name, which is displayed on messages you send.

Finally, tap **Next** to complete the setup process.

12:05

78%



Your account is set up and
email is on its way!

Account name (optional)
account@example.com

Your name
John Smith

Displayed on sent messages

NEXT

Please Note

If you choose to perform a manual setup or would like to use a POP3 account instead, you can find the necessary settings below.

SETTING	FOR IMAP	FOR POP
Server	imap.ionos.com	pop.ionos.com
Security type	SSL	SSL
Port	993	995

SETTING	YOUR INPUT
SMTP server	smtp.ionos.com
Security Type	TLS (Accept all certificates)
Port	587
Login Requires Checkbox	
Username	The full email address of your 1&1 IONOS email account.
Password	The password you entered when setting up the 1&1 IONOS email address.